

SITE AREA APPROX. 1.1 AC (47,742 SF)  
BUILDING AREA (2 FLOORS) 20,000 SF  
COVERAGE 41.9%

PARKING REQUIRED @ 6.5 SPACES / 1000 SF 110 SPACES  
PARKING PROVIDED 103 SPACES  
PROVIDED RATIO 5.15 SPACES / 1000 SF

### TABULATIONS

1. ANY PROPOSED DEVELOPMENT IS SUBJECT TO APPROVAL OF GOVERNMENT AGENCIES. BUILDING AREA AND LAND COVERAGE ARE PRELIMINARY AND SUBJECT TO ADJUSTMENT.

### NOTES

The use of other project documents not of this, landscape and design incorporated herein are instruments of service, all of which are hereby incorporated by reference. LPA, LPA and LPA are used in writing and in print for any project or project phase as indicated in the legend.

Project documents include: LPA and Client. LPA hereby gives formal notice that the use of project documents, including all data and graphics, is limited to the project and site of the project. LPA and LPA are not responsible for any errors or omissions in this document, and shall not be held liable for any errors or omissions in this document, and shall not be held liable for any errors or omissions in this document, and shall not be held liable for any errors or omissions in this document.

© Copyright 2007

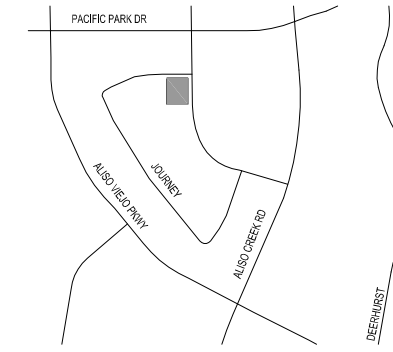

VICINITY MAP 1"=500'

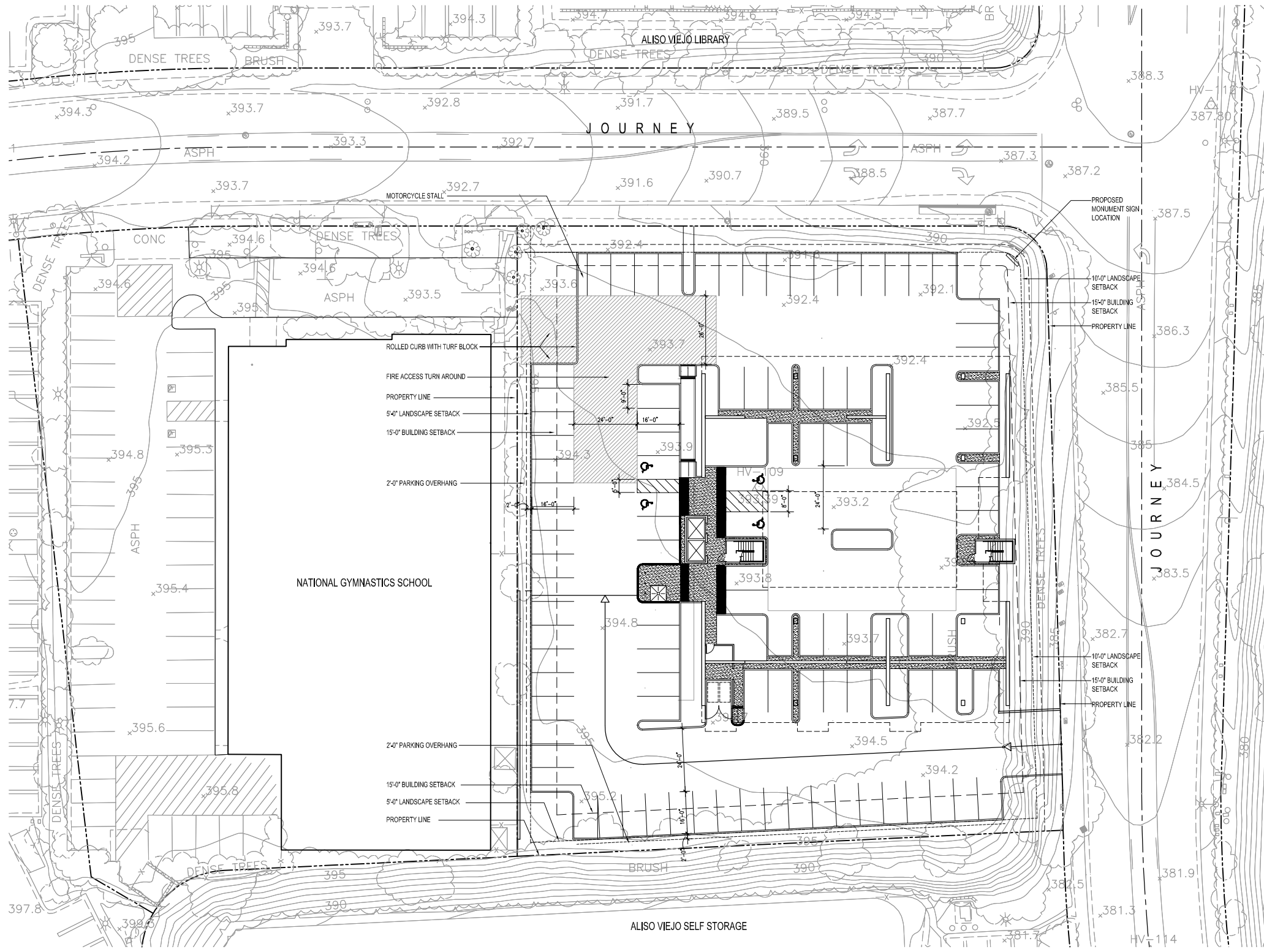

SITE PLAN

**2 JOURNEY**  
ALISO VIEJO, CA  
Developed for  
ACS DEVELOPMENT INC.

Scale 1/8" = 1'-0"

32  
16  
8  
0

creating places and spaces that enrich the lives of those who use them.

28091.10 14 OCT 08

Any proposed development is subject to approval of government agencies. Building area and land coverage are preliminary and subject to adjustment.